

Bagotte

Juice Extractor

User manual

BE100



Please Read Instructions Carefully Before Assembly
Retain This Manual For Future Reference

Table of content

General description	1
Attentions	2
Advantage	3
Notes for use	3
Notes	3
Juicing	4
Function Description	4
Assembling	5
Maintenance and cleaning	6
Trouble shooting	6
Product Safety Indexes	7

General description

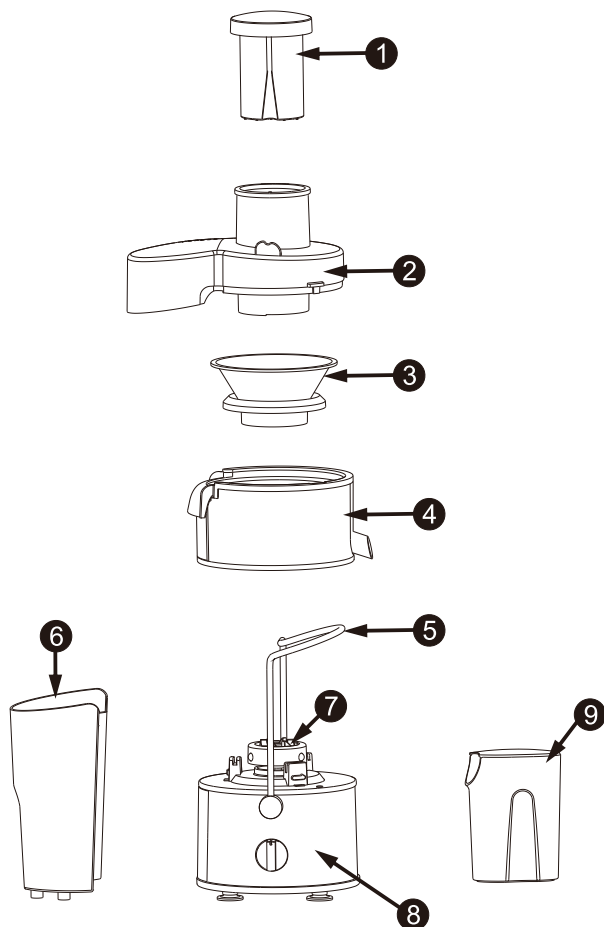

- 1. Pushing bar
- 2. Transparent cover
- 3. Juicing net
- 4. Middle ring
- 5. Handle

- 6. Residue barrel
- 7. Transposition
- 8. Main machine
- 9. Juice jug

Attentions

1. This machine is unavailable for the weakness, unresponsive or psychopathic person (including children), unless under the direction or help from the person who has the responsibility for security. Children should be overseen, so it can be testified that they are not playing with it.
2. Before using, put this machine on a stable and even table board, operate according to the above methods.
3. Always disconnect the appliance from the supply if it is left unattended and before assembling, disassembling or cleaning.
4. Before juicing, first confirm juicing net and rotor clutched in position, and no hard contact between juicing net cutter and transparent cover. Put the transparent cover on, fasten tight the handle, then turn on the machine.
5. Before being used, the motor works in running-in phase, there may be slight peculiar smell and spark, this is normal, after the motor works for some period, the above phenomenon will disappear.
6. During juicing, make sure there is not too full juice and residue in the middle seat and residue cup, if too full, please cut off power supply, clean up, then use again.
7. During using, do not open the cup cover. In case power supply is on, do not put hand or any ware into the mixing cup or feed port, otherwise, harmful accident may occur or this machine may be damaged.
8. In order to prolong service life of this machine, over-temperature protective device is mounted in the motor. If the motor works for a long time or overloaded, when over warning temperature, power supply will automatically cut off. After the motor stops, pull out plug of power supply, wait for the motor to cool (about for 30 min), use again.
9. During operating, please do not leave, never let children operate this machine. When this machine works in mixing, mincing or grinding conditions, no-loaded or over loaded 10. work is strictly prohibited.
11. After operation, do not pour the food out until pull out the plug of power supply.
12. Cutters are very sharp, in order to avoid danger, when cleaning a cutter, please put the cutter under water tap for washing, do not wash it with hand.
13. This machine must not be used for others beyond regulated purposes.
14. In case of damaged power supply cord, in order to avoid danger, replacement must be performed by the manufacturer or its service department or similar professional persons.



The symbol on the product or its packaging indicates: Do not dispose of electrical appliances as unsorted municipal waste, use separate collection facilities. Contact your local authority for information regarding the collection systems available. If electrical appliances are disposed of in landfills or dumps hazardous substances can leak into the groundwater and get into the food Chain, damaging your health and well-being. Please contact your local or regional waste authority for more information on collection, reuse and recycling programs.

Advantage

1. Design is fine, simple, and beautiful, with combined structure, easy to operate and clean.
2. High speed electric motor with overheating protection is adopted, high efficiency, time saving, energy saving, high service life of the motor.
3. Safety lock unit for switching is specially designed, in order to make sure safety and reliability in use.

Notes for use

Notes

1. Before using, please confirm the button switch of the main machine in stop state, in this way, in case assembly is not completed, starting the main machine can be avoided, so unnecessary damage for persons or property avoided.
2. Before juicing, first confirm juicing net and rotor clutched in position, and no hard contact between juicing net cutter and transparent cover. Put the transparent cover on, put the handle into the cover slot, then turn on the machine.
3. When disassembling juicing net, first remove the cover and residue barrel, then put up the middle ring by holding juicing nozzle with your hand, and take up, the juicing net will automatically leave the rotor.
4. For using, assemble according to the diagram of "name and position of main components". Turn on power supply, press switch to let the machine run no-load for 5 sec. Put prepared vegetable or fruit into feed port of the juicer, press with the pushing bar, evenly, hard and slowly, juice of the vegetable or fruit can be found, original, fresh, good for health.
5. Note: when pressing food with the pushing bar, force shall be even or indirect, pressing force shall not be more than 1 kg, no too sudden force, otherwise, juicing effect will be reduced.
6. This machine is set with safety unit, when the handle does not fasten the cover or the cutter seat is not fastened, the motor cannot turn, so as to ensure safety for the user.
7. In order to avoid damage, before using, first check power supply for compliance with rated voltage .
8. Clean all parts able to disassemble (refer to the section of "maintenance and cleaning").
9. Please carefully read the "attentions" before using.

Juicing

*Please read the following contents before use

1. The materials should be put into the machine slowly one by one. New materials should be put only after the previous materials have been squeezed.
2. The materials with large fiber content (such as celery) should be cut into small size (1-2cm). (The materials with particularly strong fiber should be put into the machine slowly after being cut into the blocks of about 3cm).
3. When the carrot that have been stored at low temperature for over 1 year is used for squeezing, it is better to make it squeezed together with the materials which have high moisture content (such as pear or orange). Because such carrot has less water content. The juice amount will be more, if new materials are put into the machine after the previous materials have been squeezed (the juice amount will vary with the water content of materials).
4. The juice amount would be less if the materials are not fresh. When dry materials stored in refrigerator are used for squeezing, the materials should be squeezed after being immersed in clear water for sufficient water absorption, so that the effect will be better.
5. Hard materials are not applicable to make juice (such as kudzu, sugarcane, etc.)
6. There will be certain friction noise when carrot (hard flesh) or apple (hard peel) is used for squeezing, but it won't have bad impact on the product.
7. Juice might be splash from the feed inlet when such materials as cherry tomatoes and grapes are used for squeezing.
8. For juicing, select strong grading, for operating time, after operating for 1min, stop for 1min, then use again. After the above operation is performed for three times, stop for 15 min, do not operate until the motor is cooled, in this way, service life of this machine will be prolonged, the machine will serve you more efficiently.

Function Description

Centrifugal juicers are suitable for extracting juice from fruits or vegetables. The juice will flow from the Juice Spout into the Juice Jug, and the residual fruit pulp will automatically enter the Pulp Container. Fruits must be juicy such as apples, cucumbers, etc.

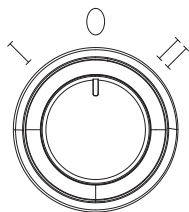

Speed I: for softer fruits such as Watermelons, Pears

Speed II: for Apples and Carrots etc.

Note: If you use Speed II to extract juicy fruit you will end up with less juice compare use Speed I.

Assembling

1. Put the middle ring onto the main machine.

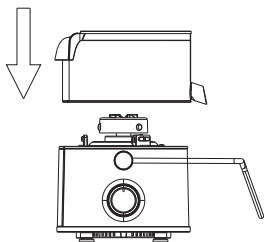

2. Put the juicing net onto the middle ring and press it slightly so that they're fitting together.

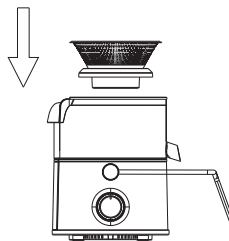

3. Put down the transparent cover on the middle ring.

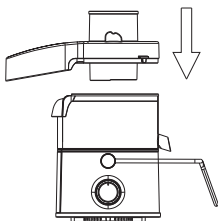

4. Lock the handle on the transparent cover.

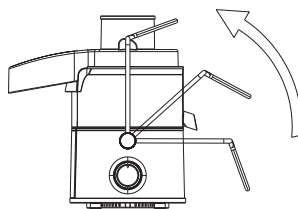

5. Install the residue barrel to the machine.

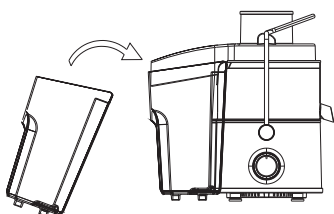

6. Turn on the machine and put the fruits into feeding tube, then use pushing bar to press the fruits slightly.

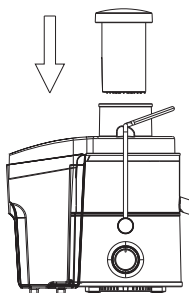

7. Place the Juice Jug provide under the spout. It is now to prepare the operating device.

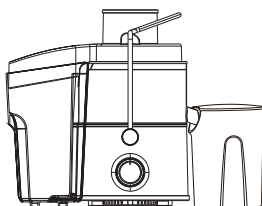

Maintenance and cleaning

1. This machine shall be often used, so as to keep the motor dry and clean.
2. If not using for a long time, please store this machine at a dry and well-ventilated place so as to prevent the motor from being damped and going moldy.
3. No washing the main machine. When cleaning, only wipe with wet cloth. Other components may be washed directly with water, such as pushing bar, cover, middle seat, residue cup, juice nozzle cover.

Trouble shooting

Problem	Solution
The appliance doesn't work	Please check whether the appliance is plugged and it is assembled correctly.
The motor is smelling abnormally	It is normal that there's smell from motor at the beginning usage, the smell will be disappeared after several usage. Too long working time may cause abnormal smell, under this case, please turn it off and let it cool down for 60 mins.
The filter blade or motor unit is blocked during operation.	Turn off and disassemble the appliance, then clean up the blocked fruits.
Can use boiled water to clean the components?	Can not, please let the water cool down to 60 degree then can clean the components.
Can put the detachable components into dishwasher machine?	Can not clean the motor unit by dishwasher machine.

Product Safety Indexes

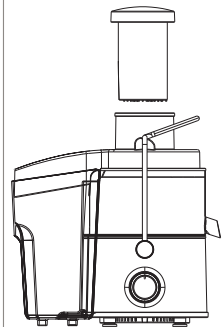

Product	Juice extractor
Model no.	BE-100
Rated voltage	120V(US) 220-240(EU)
Rated frequency	60Hz(US) 50/60Hz(EU)
Rated power	400W(US) 600W(EU)
Norminal time	≤1 minute
Residue barrel	1400ml
Juice jug	500ml
Feeding tube	65mm

